

E-ABCardA-04-20	4 Panel dip card w/Adulteration Strip, AMP1000/COC300/OPI2000/PCP (OX/SG/pH) *NO THC (E&I)
E-NMCardA-05-18	5 panel dip card w/Adulteration Strip, AMP1000/COC300/OPI2000/PCP25/THC50 (OX/SG/pH) (E&I)
E-ABCardA-07-34-BT	7 Panel dip card, w/Adulteration Strip AMP1000/COC300/mAMP1000/MDMA500/OPI2000/OXY100/THC50 (OX/SG/pH) (E&I)
E-NMCardA-10-51-BT	10 Panel dip card w/Adulteration Strip, AMP1000/BAR300/BZO300/COC300/mAMP1000/MDMA500/MTD300/OPI2000/OXY100/THC50 (OX/SG/pH) (E&I)
G-NMCard-01-EG	One Panel Dip Card, ETG500 (FUO)
G-ABCard-12-66	12 Panel dip card, 6AM10/AMP300/COC150/BZO200/FEN50/MDMA500/MET500/MTD300/OPI300/OXY100/PCP25/TCA1000 (FUO)
G-NMCard-13-30-BT	13 Panel dip card, AMP500/BAR300/BUP10/BZO300/COC150/FEN50/MDMA500/MET500/MTD300/OPI300/OXY100/PCP25/THC50 (FUO)
G-NMCardD-13-33	13 Panel dip card w/Adulteration Strip, AMP500/BAR300/BUP10/BZO300/COC300/ETG500/FEN50/MDMA500/MET500/MTD300/OPI300/OXY100/THC50 (CR/OX/pH) (FUO)
NMCard-05-02-BT	5 Panel dip card, AMP500/COC150/MET500/OPI300/THC50 *CLIA WAIVED
NMCard-10-16-BT	10 Panel dip card, AMP500/BAR300/BZO300/COC150/MET500/MTD300/OPI300/OXY100/PCP25/THC50 *CLIA WAIVED
NMCard-12-02-BT	12 Panel dip card, AMP500/BAR300/BUP10/BZO300/COC150/MDMA500/MET500/MTD300/OPI300/OXY100/PCP25/THC50 *CLIA WAIVED
ABCardD-12-01-BT	12 Panel dip card w/Adulteration Strip, AMP500/BAR300/BUP10/BZO300/COC150/MDMA500/MET500/MTD300/OPI300/OXY100/TCA1000/THC50 (CR/OX/pH) *CLIA WAIVED
NMCardA-10-20-BT	10 Panel dip card w/Adulteration Strip, AMP500/BUP10/BZO300/COC150/MDMA500/MET500/MTD300/OPI300/OXY100/THC50 (OX/pH/SG) *CLIA WAIVED

- **Accurate**
- **Affordable**
- **Min. Vol. To Run is 5 mL**
- **Negative Results in > 1 minute**
- **Available in CLIA Waived 501K, Forensic Use, Insurance**



Multi-Drug Screen Card

For Rapid Drug & Alcohol Screening

19525 Janacek Ct, Suite 104 Brookfield, WI 53045 +1 262.432.9308

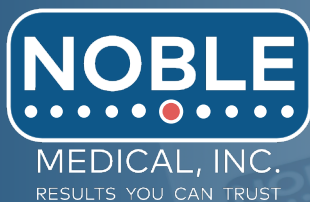

- **Accurate**
- **Affordable**
- **Min. Vol. To Run is 5 mL**
- **Negative Results in > 1 minute**
- **Available in CLIA Waived 501K, Forensic Use, Insurance**

Multi-Drug Screen Card

For Rapid Drug & Alcohol Screening

19525 Janacek Ct, Suite 104 Brookfield, WI 53045 📞 +1 262.432.9308

Step 1

Remove the dip card from the sealed pouch. If required by your process, write the donor name or ID on the dip card in the provided space, and then remove the cap.

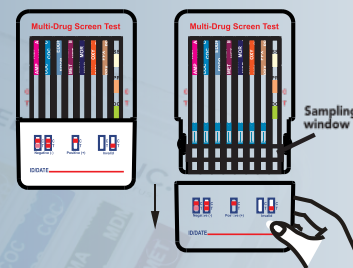

Step 2

Initiate the test by either 2.a or 2.b below:

2.a If the volume of urine specimen excess the Sampling Window, immerse the dip card into the urine for minimum of 1 second.

2.b Immerse the dip card vertically into the urine and leave the device in the urine cup throughout the testing process.

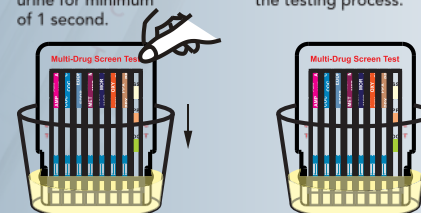

Step 3

Negative results can be interpreted as soon as the control lines appear which usually occur within 1 minute. Positive drug screen test results should be read at 5 minutes. All results remain stable for 60 minutes.

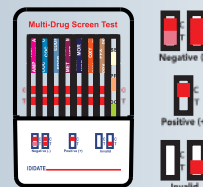

Step 4

Read Specimen Validity Test (SVT) results by comparing the color of the reagent pads to the corresponding color blocks on the color chart at 3 to 5 minutes.

